

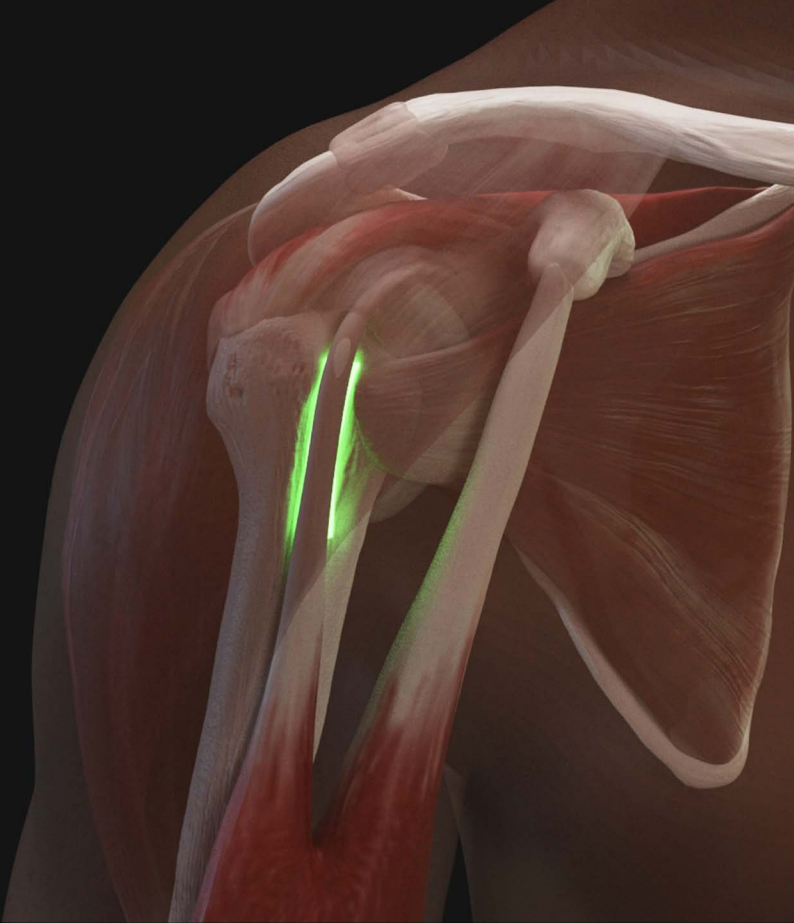

## USER GUIDE



# SHOULDER INJECTION TRAINER ULTRASOUND GUIDED

This product is available  
in light and dark skin tones

**70202**

**70221**

FOR MORE SKILLS TRAINING PRODUCTS VISIT

**[limbsandthings.com](https://limbsandthings.com)**

Sussex Street, St Philips, Bristol, BS2 0RA, UK | [sales@limbsandthings.com](mailto:sales@limbsandthings.com) | +44 (0) 117 311 0500

## INDEX

PACKAGE SUPPLIED	3
SAFETY & CLEANING INSTRUCTIONS	4
SET UP	7
• FILLING JOINTS	7
• FILLING BURSA TO SIMULATE BURSITIS	9
CARE & MAINTENANCE	10
• REPLACING THE SHOULDER MODULE	10

TAKE A LOOK  
AT OUR **VIDEO**



VISIT THE WEBSITE  
**[limbsandthings.com](https://limbsandthings.com)**

OR YOUTUBE CHANNEL  
**[youtube.com/limbsandthings](https://youtube.com/limbsandthings)**

## PACKAGE SUPPLIED

Shoulder  
Torso

70215

70226



Shoulder Module  
Ultrasound Guided

70213

70224



Elbow



Needle Set

70108



Filling Kit

70217

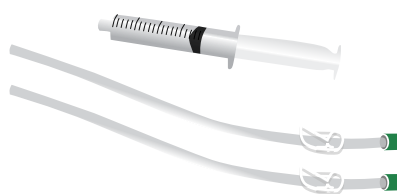

Synovial Fluid (250ml)

70022



Carry Case



## YOU WILL NEED (NOT SUPPLIED)

Linear Probe



Ultrasound Gel



## SAFETY & CLEANING INSTRUCTIONS

READ THE SAFETY INSTRUCTIONS CAREFULLY  
BEFORE USING YOUR SHOULDER INJECTION TRAINER

### DO's



Follow all instructions.  
Keep these instructions.  
Heed all warnings.  
Handle with care.

Use needles provided or near  
new needle of 21 gauge.



Refer all servicing to qualified service  
personnel. Servicing is required when the  
apparatus has been damaged.

Clean the product with a damp  
soft cloth or sponge, using only  
warm water with mild detergent.



### DON'Ts



Do not install near any heat sources,  
do not expose the product to flames  
or use near naked flame sources.  
Do not use flammable solvents near or  
on this product.

Do not over rotate/move the shoulder as  
this can damage the product.



Do not overfill the joints.

Do not fill the model without using  
the filling kit (70217)



## STORAGE & TRANSPORTATION



Always ensure that the products are properly  
packed and secured during transportation  
and storage in order to prevent personal  
injury or damage to the product.



**THE ULTRASOUND SHOULDER MUST BE STORED CAREFULLY**

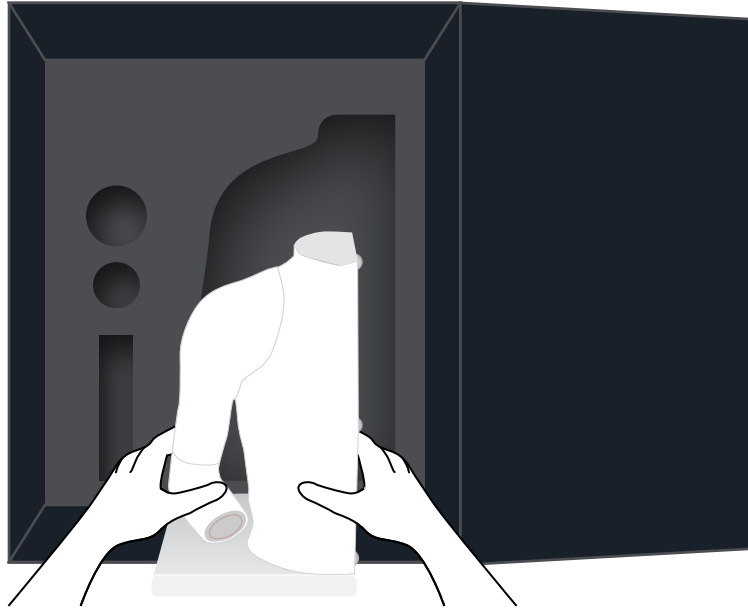

The Ultrasound Shoulder is extremely delicate, use carefully and store in its protective carry case.





## THE ULTRASOUND MODULE MUST BE STORED CAREFULLY

\* Applicable to 70214/70225 & 70213/70224 only

The Shoulder Ultrasound Module is extremely delicate, make sure it is stored everytime after use in its protective box.

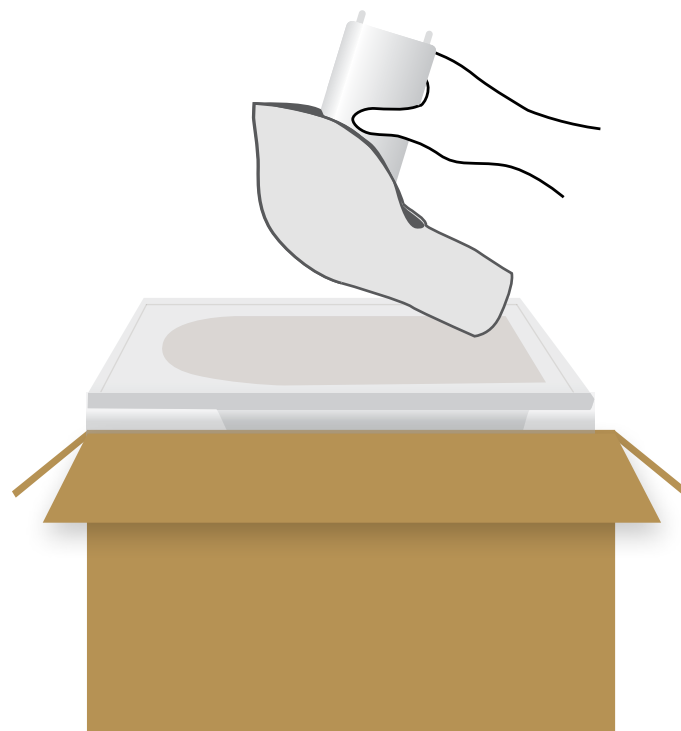
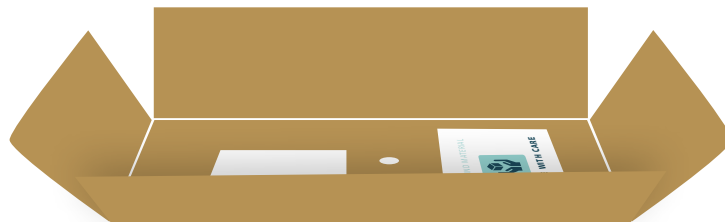
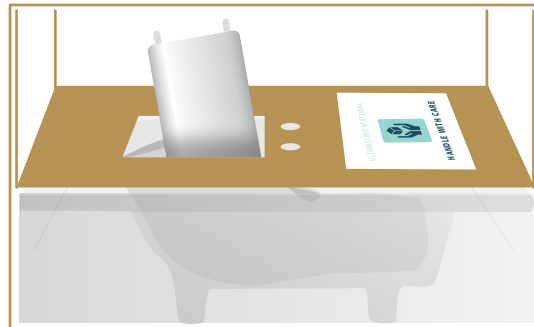

## SET UP

## FILLING JOINTS

1 Fill syringe

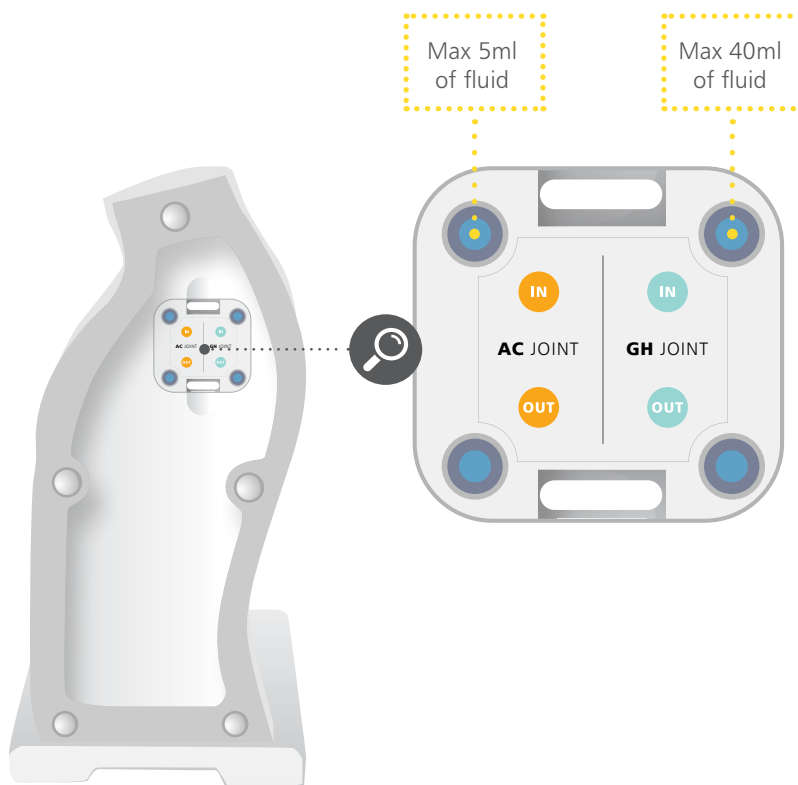

2 Push and then screw on the tube

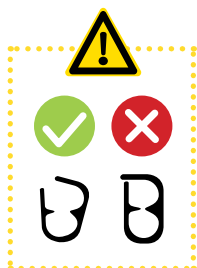

## SET UP

## FILLING JOINTS

- 3 Push and then screw on the syringe

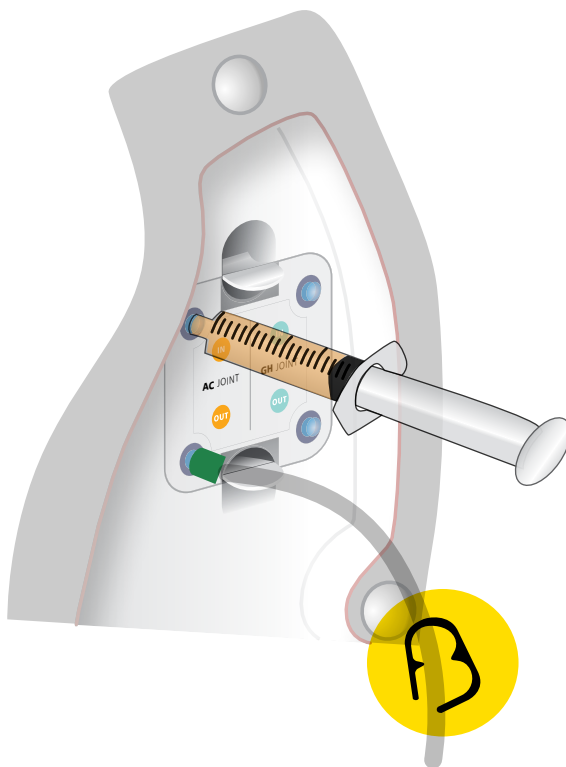

- 4 Inject fluid from syringe into joint until it starts coming out from the tube

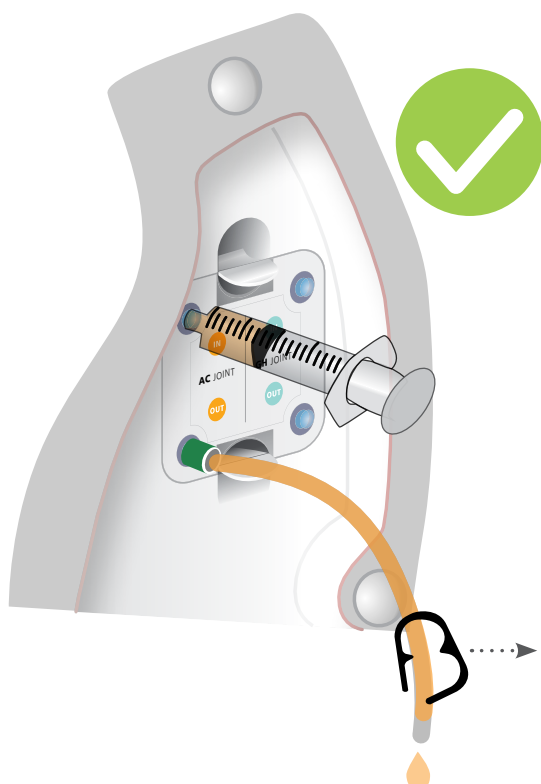

PLEASE CHECK FILLING KIT IS  
SET UP CORRECTLY BEFORE  
INTRODUCING FLUID

## SET UP

## FILLING BURSA TO SIMULATE BURSITIS

### ACROMIOCLAVICULAR JOINT

- 1 Inject fluid from syringe into joint until it starts coming out from the tube

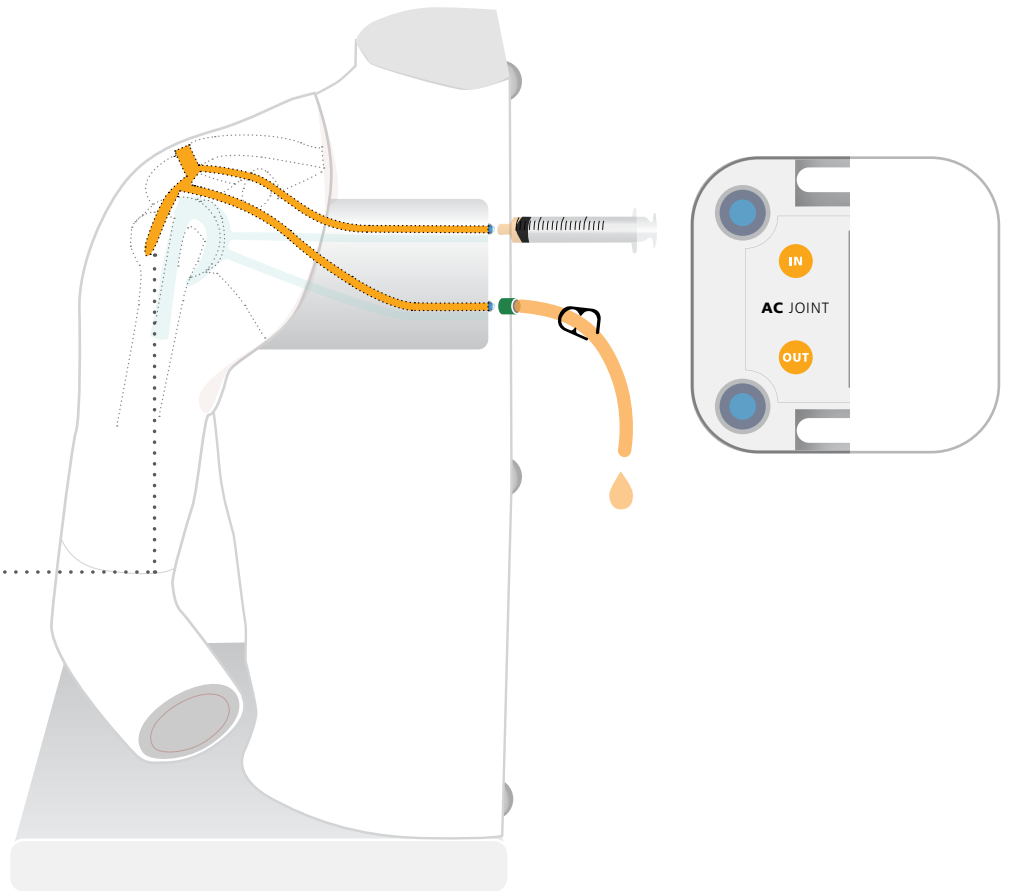
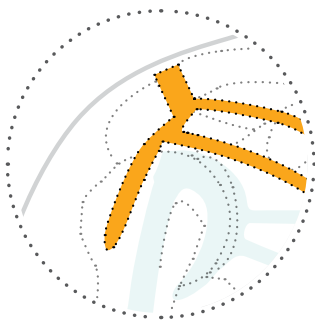

- 2 Close the tube and add another 5ml of fluid

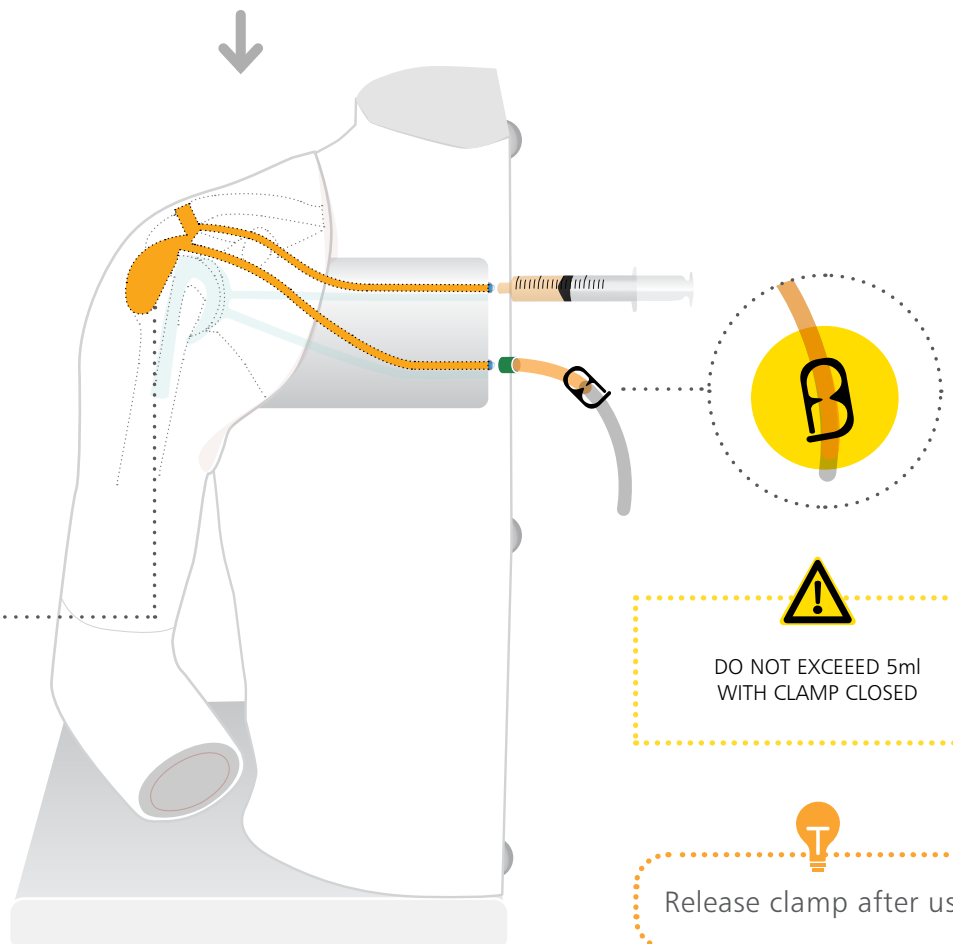
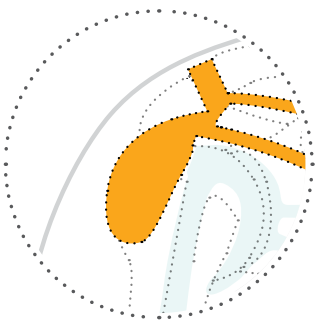

1 Remove shoulder from torso

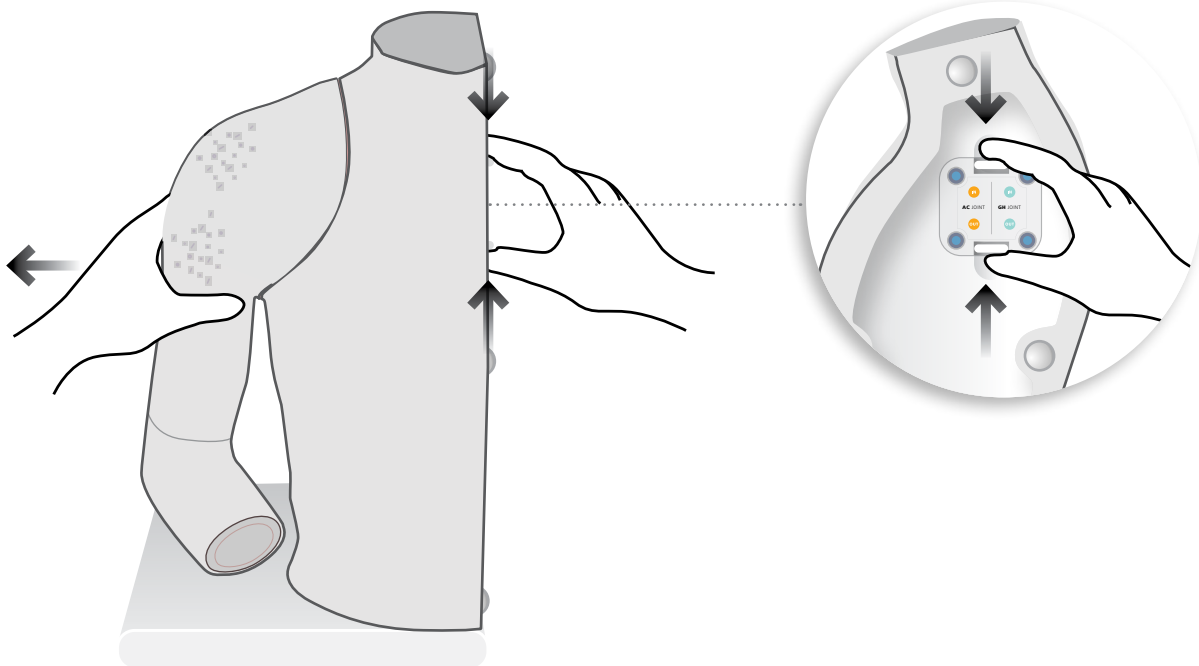

2 Remove the elbow

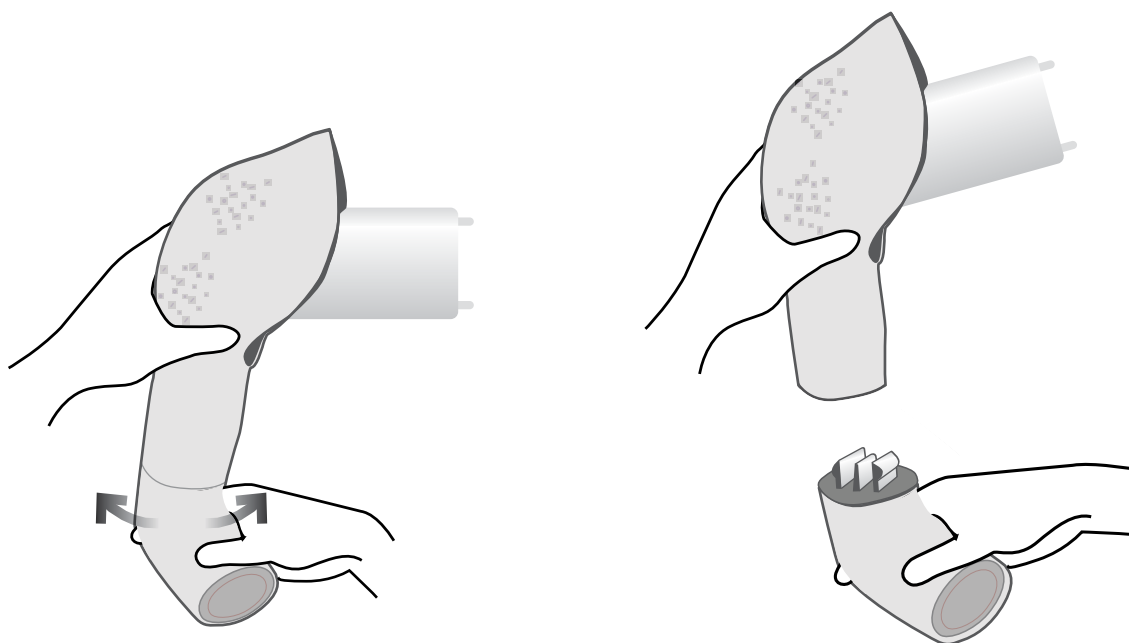

### 3 Attach the elbow to new module

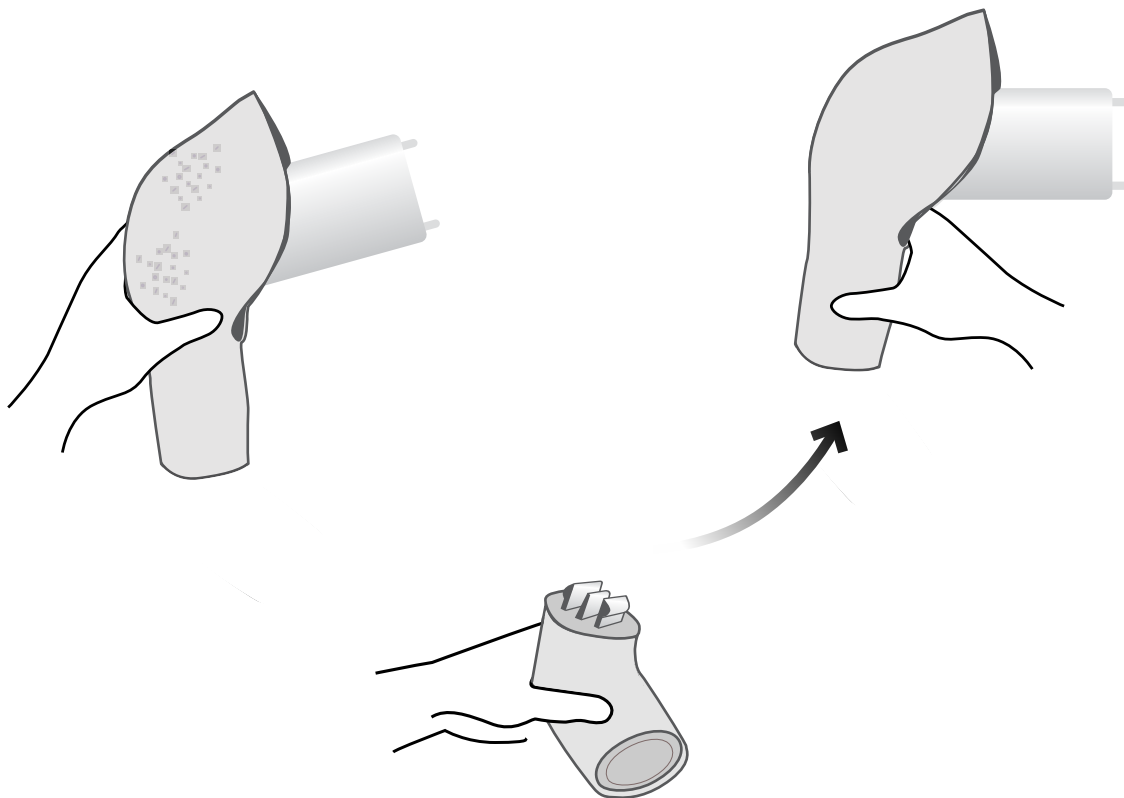

### 4 Mount shoulder into torso

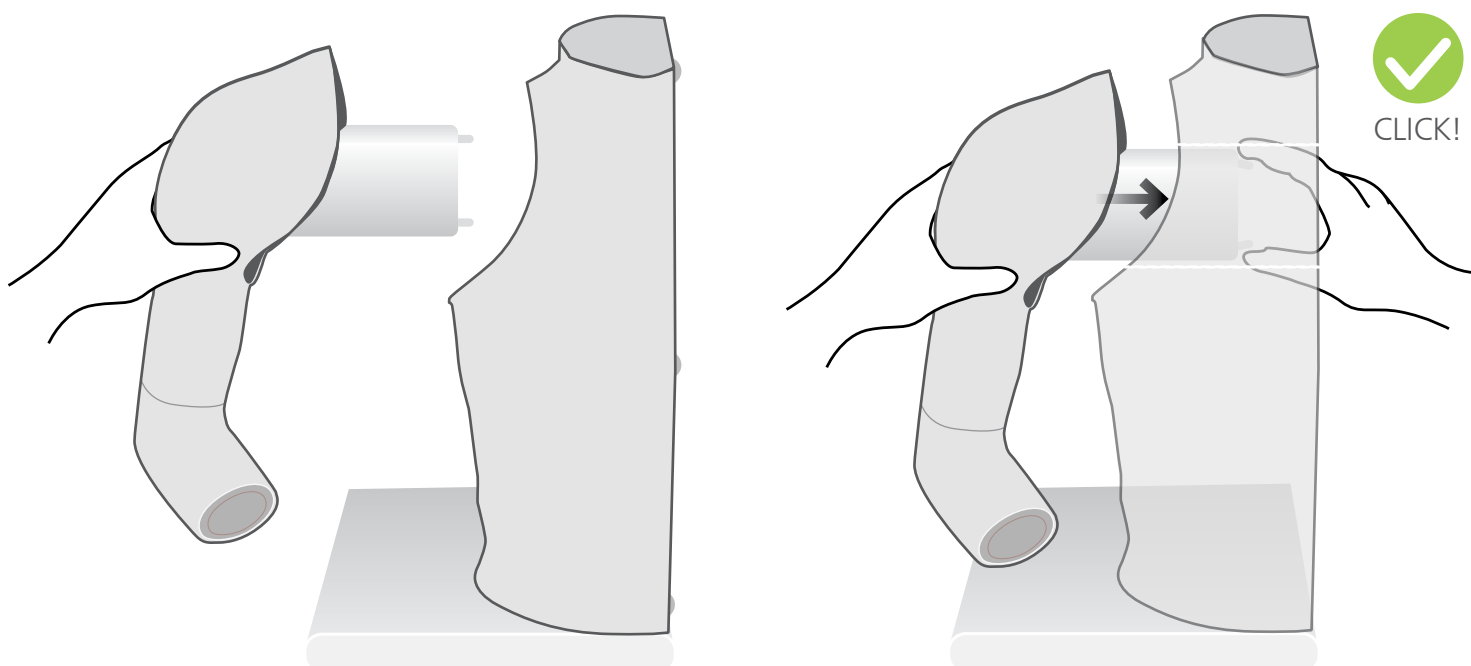

YOU MAY  
ALSO BE  
INTERESTED IN...

SONON  
ULTRASOUND  
IMAGING SYSTEM  
LINEAR

**HC300L**



KNEE ASPIRATION &  
INJECTION TRAINER  
WITH ULTRASOUND  
CAPABILITY

**70103** **70114**

